

ISSUE DATE	ISSUED FOR
01.28.2022	BIDS
02.16.2022	ADDENDUM 1

DRAWN	BMJ
CHECKED	SJB
APPROVED	SM

KEY PLAN

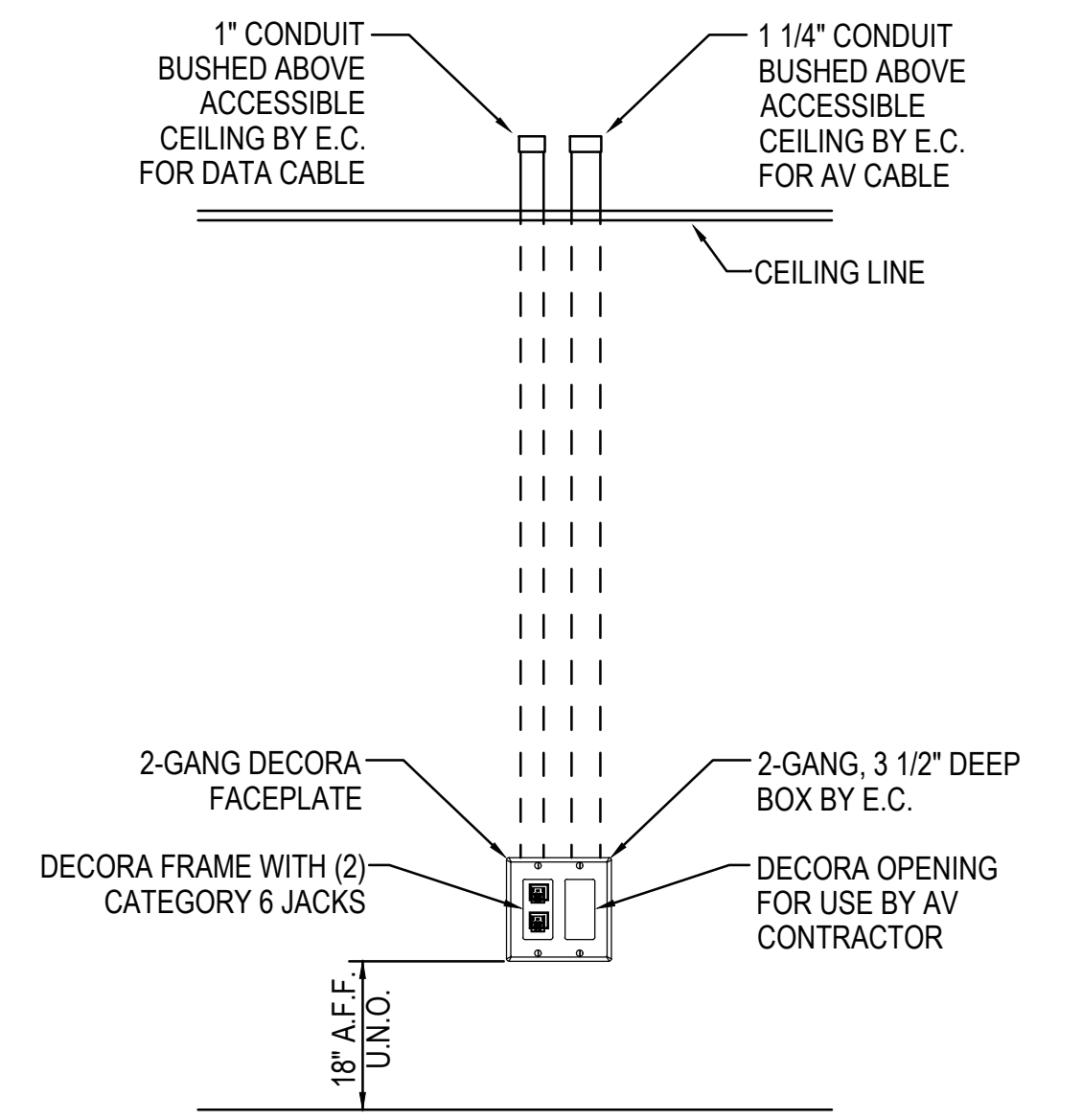

1 TEACHER STATION LOCATIONS

N.T.S. SYMBOLS:

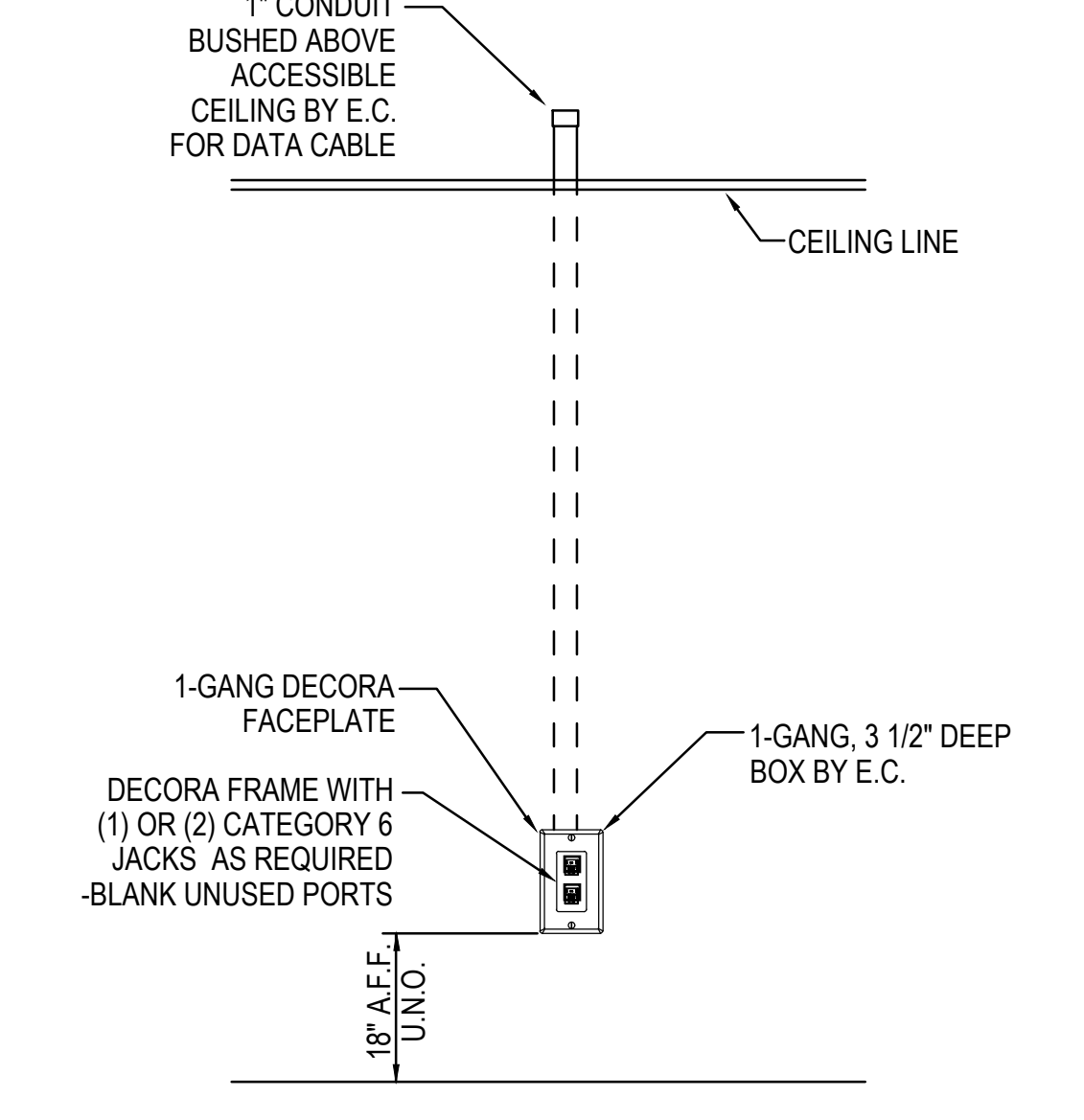

2 SINGLE & DOUBLE DATA LOCATIONS

N.T.S. SYMBOLS:

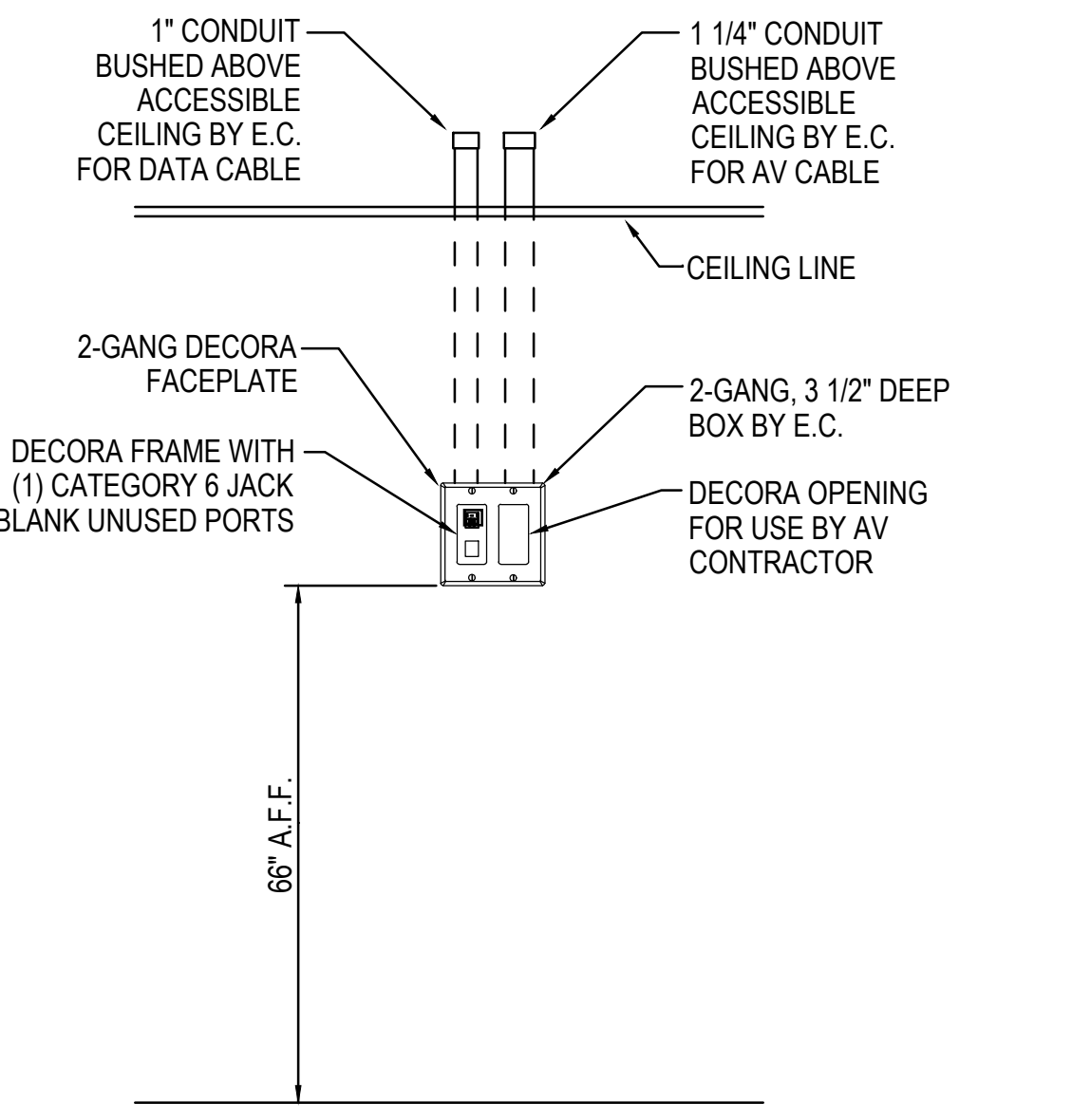

3 INTERACTIVE FLAT PANEL LOCATIONS

N.T.S. SYMBOLS:

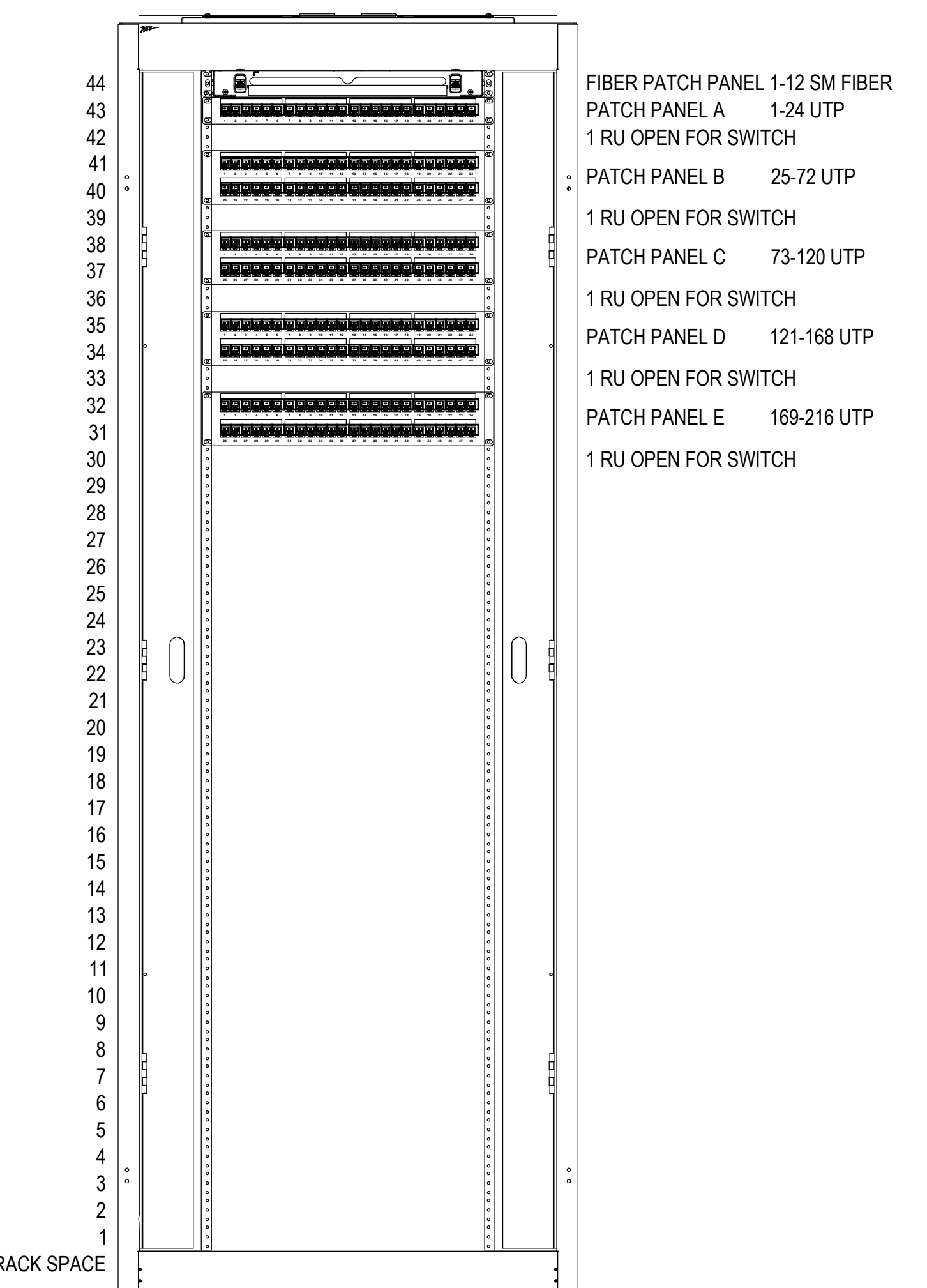

4 EQUIPMENT CABINET LAYOUT

N.T.S.

PROJECT

Structured Cabling System



Clawson Public Schools
 Clawson, Michigan

SHEET

CLAWSON MIDDLE SCHOOL
 STRUCTURED CABLING DETAILS

PROJECT NUMBER

22-CPS-SCS-01

SHEET NUMBER

T4.1

ISSUE DATE	ISSUED FOR
02.16.2022	ADDENDUM 1

DRAWN	BMJ
CHECKED	SJB
APPROVED	SM

KEY PLAN	
-----------------	--

PROJECT	
----------------	--

Structured Cabling System

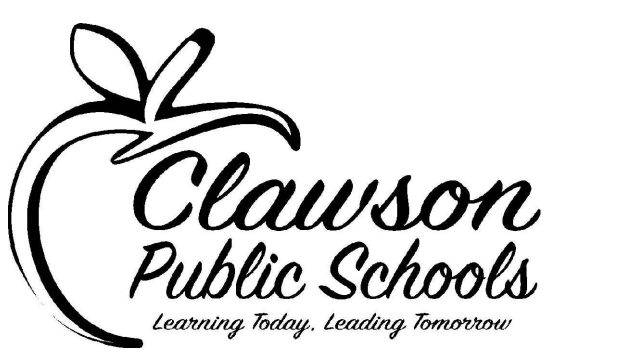

Clawson Public Schools
Clawson, Michigan

SHEET	
--------------	--

CLAWSON MIDDLE SCHOOL
& CLAWSON HIGH SCHOOL
COMPOSITE / FIBER OPTIC
BACKBONE PLAN

PROJECT NUMBER	
-----------------------	--

22-CPS-SCS-01

SHEET NUMBER	
---------------------	--

T0.1

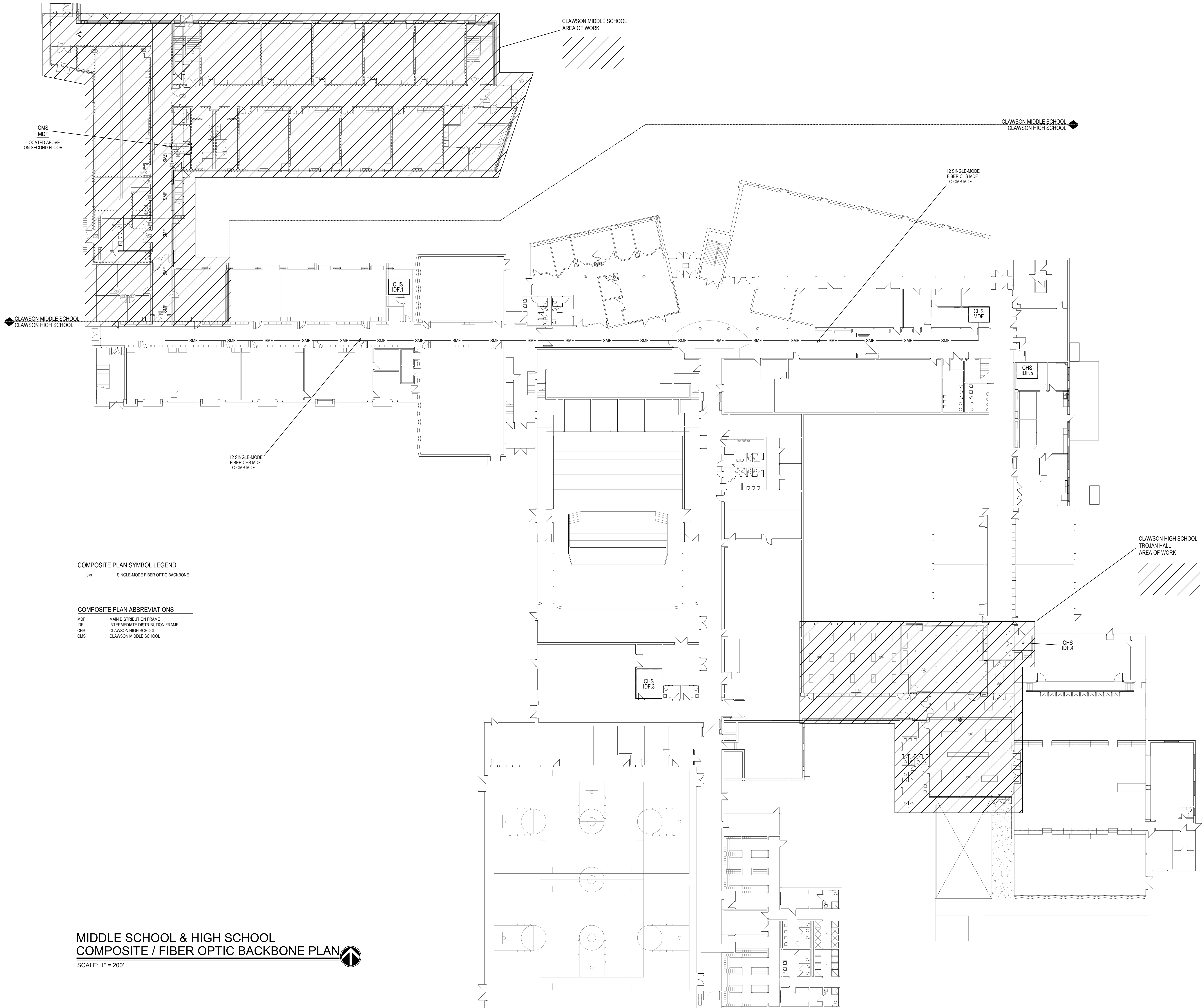

COMPOSITE PLAN SYMBOL LEGEND

SMF SINGLE-MODE FIBER OPTIC BACKBONE

COMPOSITE PLAN ABBREVIATIONS

MDF	MAIN DISTRIBUTION FRAME
IDF	INTERMEDIATE DISTRIBUTION FRAME
CHS	CLAWSON HIGH SCHOOL
CMS	CLAWSON MIDDLE SCHOOL

MIDDLE SCHOOL & HIGH SCHOOL
COMPOSITE / FIBER OPTIC BACKBONE PLAN

SCALE: 1" = 200'

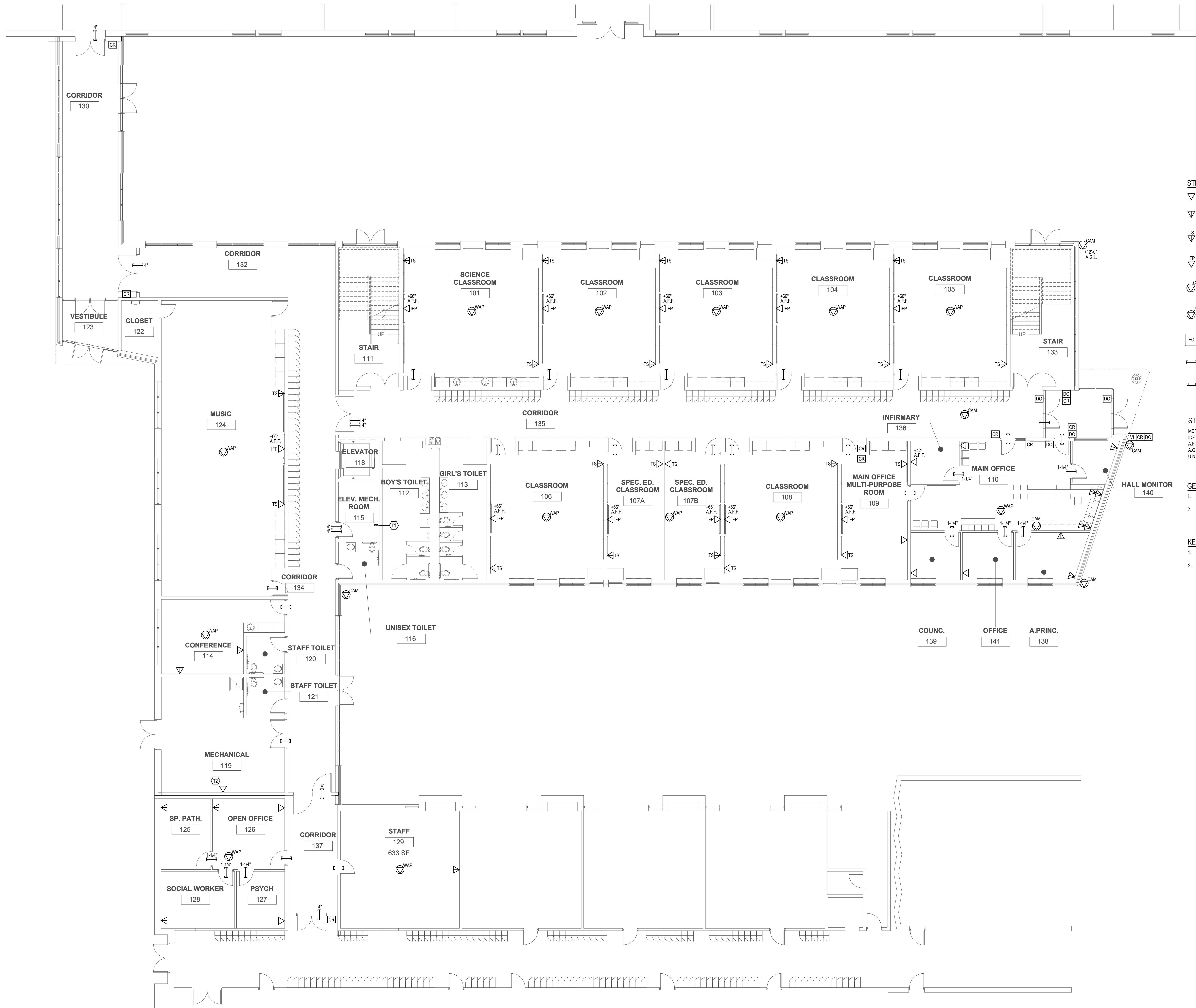

STRUCTURED CABLING SYMBOL LEGEND

- ▽ SINGLE DATA OUTLET - WALL MOUNTED 1-GANG ONE (1) CATEGORY 6 UTP
- ▽ DOUBLE DATA OUTLET - WALL MOUNTED 1-GANG TWO (2) CATEGORY 6 UTP
- ▽ DOUBLE DATA OUTLET - WALL MOUNTED 2-GANG FOR TEACHER STATION TWO (2) CATEGORY 6 UTP
- ▽ SINGLE DATA OUTLET - WALL MOUNTED 2-GANG FOR INTERACTIVE FLAT PANEL ONE (1) CATEGORY 6 UTP
- ▽ SINGLE DATA OUTLET - IN CEILING SURFACE MOUNTED FOR SECURITY CAMERA ONE (1) CATEGORY 6 UTP
- ▽ SINGLE DATA OUTLET - IN CEILING SURFACE MOUNTED FOR WIRELESS ACCESS POINT ONE (1) CATEGORY 6A UTP
- EQUIPMENT CABINET
- ┌ CONDUIT SLEEVE - 2" U.N.O. PROVIDED BY ELECTRICAL CONTRACTOR
- └ SECONDARY BONDING BUSBAR PROVIDED BY ELECTRICAL CONTRACTOR

STRUCTURED CABLING ABBREVIATIONS

- MDF MAIN DISTRIBUTION FRAME
- IDF INTERMEDIATE DISTRIBUTION FRAME
- A.F.F. ABOVE FINISHED FLOOR
- A.G.L. ABOVE GROUND LEVEL
- U.N.O. UNLESS NOTED OTHERWISE

GENERAL STRUCTURED CABLING NOTES

1. ELECTRICAL CONTRACTOR TO PROVIDE ALL BACKBOXES, CONDUITS, AND SLEEVES FOR STRUCTURED CABLING.
2. STRUCTURED CABLING CONTRACTOR SHALL FIRESTOP ALL SLEEVES AND CORES PROVIDED FOR STRUCTURED CABLING.

KEYED STRUCTURED CABLING NOTES

1. LOCATION OF (2) 4" SLEEVES TO COPYWORK ROOM 215 ABOVE WHERE MDF AND EQUIPMENT RACK IS LOCATED.
2. COORDINATE EXACT LOCATION WITH MECHANICAL EQUIPMENT CONTRACTOR.

ISSUE DATE	ISSUED FOR
01.28.2022	BIDS
02.16.2022	ADDENDUM 1

DRAWN	BMJ
CHECKED	SJB
APPROVED	SM

KEY PLAN

PROJECT

Structured Cabling System

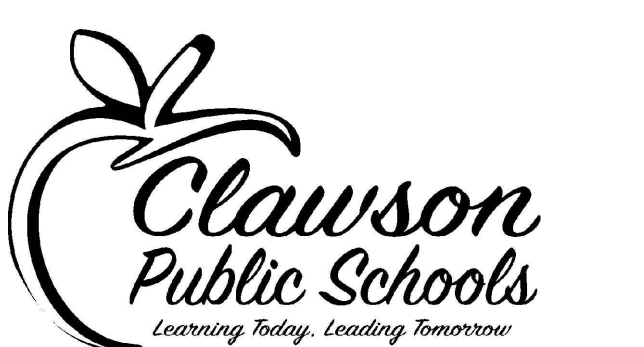

Clawson Public Schools
Clawson, Michigan

SHEET

CLAWSON MIDDLE SCHOOL
FIRST FLOOR -
STRUCTURED CABLING PLAN

PROJECT NUMBER

22-CPS-SCS-01

SHEET NUMBER

CMS.T1.1

